



Arborist Report-Memo

April 2nd, 2026

Prepared for:

David Yusen

Site Address:

3246 72nd Pl SE
Mercer Island, Wa.

Prepared by:

Douglas Smith
ISA Board Certified Master Arborist PN 6116-B
Tree Risk Assessment Qualified (TRAQ)
3907 Aurora Ave N.
Seattle, Wa. 98103
(206)457-5706
doug@seattletreeconsulting.com

Arborist Memorandum

Subject: Site Plan Review & Tree Protection Measures

Project Address: 3246 72nd Pl SE Mercer Island, Wa.

Date: April 2nd, 2026

Site Plan Review

The project designers have provided the most current version of the site plan for review. The plan clearly indicates the location of tree protection fencing for all trees designated for retention.

In all cases, the proposed fencing fully encloses the **Inner Tree Protection Zones (ITPZs)** and extends into the **Outer Tree Protection Zones (TPZs)** to the maximum extent practical, while still maintaining necessary site access and allowing construction crews to perform their work.

Based on our review, it is our professional opinion that the tree protection measures shown on the current site plan (see image below) are **adequate and compliant** for the protection of the retained trees.

Recommendation:

Tree protection fencing should be installed **prior to the commencement of any construction activities** and must remain in place for the **duration of the project**.

Additional Notes

Tree Identification Update (Trees #5066 and #5084)

The original inventory identified Trees #5066 and #5084 as *Crataegus douglasii* (black hawthorn). Distinguishing between black hawthorn and Scarlet hawthorn (*Crataegus laevigata*) can be challenging depending on the time of year.

A follow-up site visit was conducted in March 2026 to verify species identification. Based on observed characteristics—including the absence of red spring growth typical of black hawthorn and overall site conditions—it has been determined that both trees are **Scarlet hawthorn** (*Crataegus laevigata*).

On Mercer Island, black hawthorn is considered an exceptional tree at diameters of **6 inches DBH and greater**. With the updated identification, neither of these trees meets the criteria for exceptional status.

Tree Risk Assessment (Tree #5067)

Tree #5067 (*Thuja plicata*, western red cedar) is currently in contact with an existing structure and presents an **imminent risk of damage**.

A tree risk assessment has been completed and is included with this memo. The tree has been classified as **high risk**, and removal is recommended to prevent further structural impact.

Conclusion

The current site plan provides sufficient tree protection measures for retained trees, and no additional modifications are recommended at this time. Updates to tree identification and risk assessment have been documented and should be incorporated into project planning.

Please feel free to reach out with any questions or if additional clarification is needed.

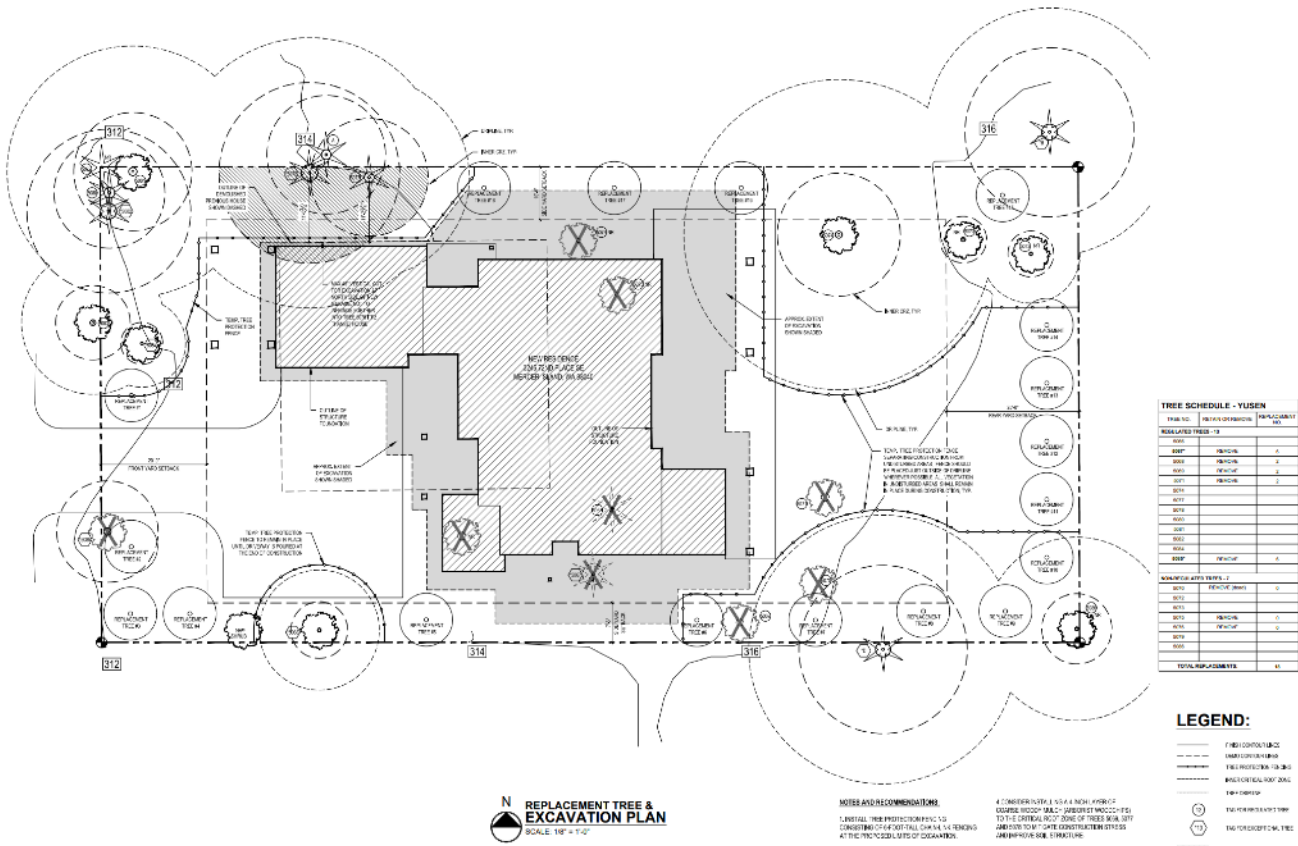

STURMAN ARCHITECT
 1000 1/2 STREET, SEASIDE, WA 98138
 360.465.1234

YUSEN RESIDENCE PERMIT SET
 3248 72ND PALISE, MERCER ISLAND, WA 98040

SITE PLAN

DATE: 11/15/2023
 DRAWN BY: J. YUSEN
 CHECKED BY: J. YUSEN
 SCALE: AS SHOWN

Assumptions and Limiting Conditions

Any legal description provided to the consultant/appraiser is assumed to be correct. Any titles and ownership to any property are assumed to be good and marketable. No responsibility is assumed for matters of legal character. Any and all property is appraised or evaluated as though free and clear, under responsible ownership and competent management.

It is assumed that any property is not in violation of any applicable codes, ordinances, statutes, or other government regulations.

Care has been taken to obtain all information from reliable sources. All data has been verified so far as possible, however, the consultant/appraiser can neither guarantee nor be responsible for accuracy of information provided by others.

The consultant/appraiser shall not be required to give testimony or attend court by reason of this report unless subsequent contractual arrangements are made, including payments of additional fees for such services as described in the fee schedule and contract engagement.

Loss or alteration of any of this report invalidates the entire report.

Possession of this report or a copy thereof does not imply right of publication or use for any purpose by any person other than to whom it is addressed, without prior written consent of the consultant/appraiser.

Neither all nor any part of the content in this report, nor copy thereof, shall be conveyed by anyone, including the client, to the public through advertising, public relations, news, sales or other media, without the prior expressed written consent of the consultant/appraiser--particularly as to value conclusions, identity of the consultant/appraiser, or any reference to any professional society or institute or to any initialed designation conferred upon the consultant/appraiser as stated in his qualification.